

Uy'Sqwuyel'! (Good Day)

Fellow Ross bay residents.

My name is Andrea Fritz and I am a local Indigenous artist, author and native plant enthusiast.

With the support of the local Fairfield Gonzales Community Association and many local volunteers, I am starting a new community garden in your area.

This garden will include local indigenous plants, both edible and visually appealing. They will be kept in a manner that is similar to a managed garden in most places while also allowing some natural evolution of the habitat to evolve.

There are three purposes to this community garden. One is to create a more natural habitat for local animals, plants and insects to thrive in. The second is to create a learning space where the community can come

to see and use beautiful local indigenous plants. These plants are able to be harvested by the community for medicinal and culinary uses. We also hope to inspire residents to use indigenous plants in their own landscaping.

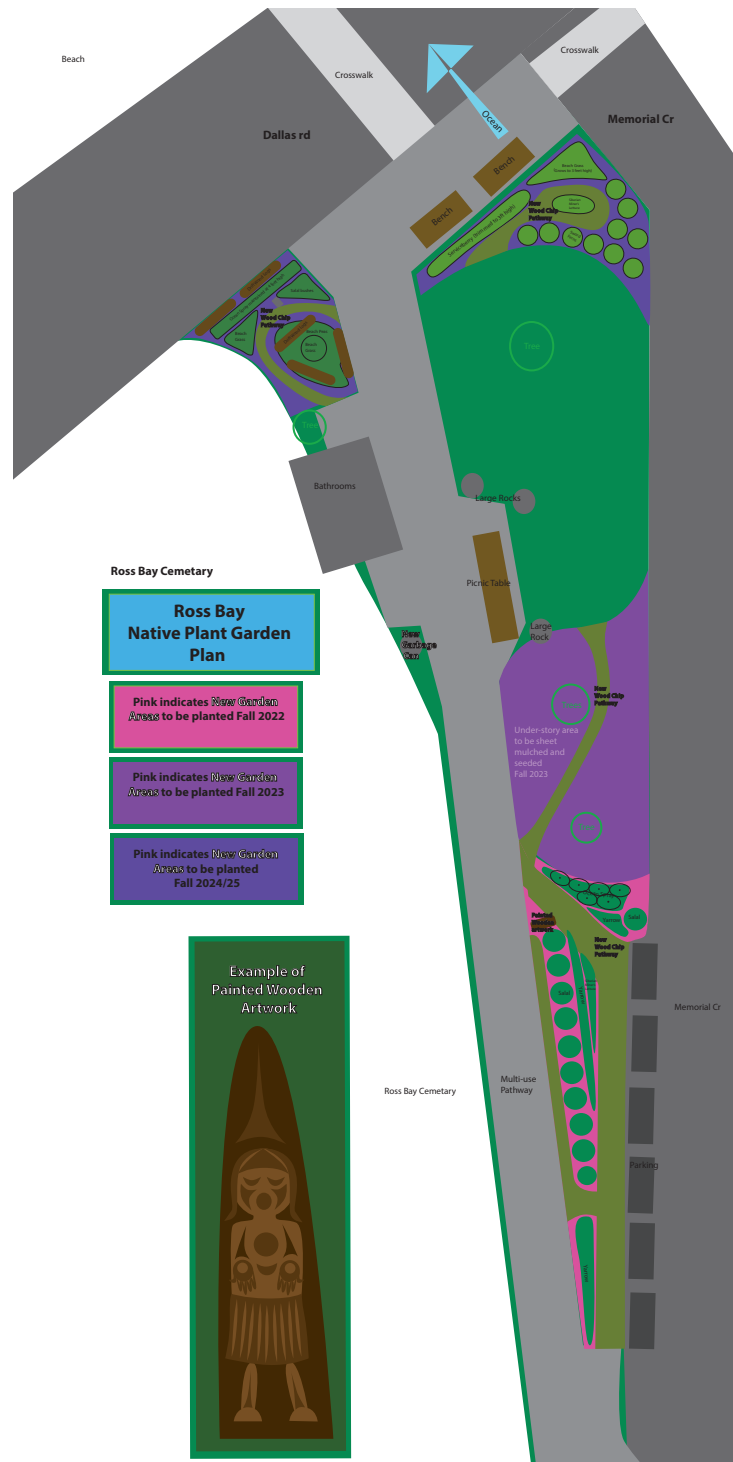

Some Frequent Questions that we have been asked about the installation of the new garden:

Where will the garden be located?

The garden will be located on Memorial crescent between Dallas rd and Bushby st, next to the Ross Bay Cemetery. The garden will be installed in stages. The first stage will hopefully be started this fall and will include the pink triangular area nearest Bushby st.

Will the garden affect my ocean view?

No, it will not. We will be using mostly short plants that grow to less than 3 ft tall. Twice yearly work-parties will be organized by the Garden volunteer coordinator at the FGCA. At these work parties, the few bushes that grow taller than 3ft such as ocean spray and snowberry, will be pruned to a manageable height so they won't impeded views before the next work party. Residents will also be able to contact the Volunteer coordinator at the FGCA through fairfieldcommunitygardens@gmail.com with any problems or concerns with the garden at any time.

Who is in charge of this garden?

The garden is sponsored by the Fairfield Gonzales Community Association at 1330 Fairfield rd. This garden will be managed by the Fairfield Community Garden's Volunteer Coordinator with input from local residents and volunteers. The garden will be maintained through volunteer work-parties. The garden is meant to be a perennial, native plant garden that is for and by the community.

How long is the garden going to be there?

The Ross Bay Native Plant Garden will be installed in 2022 or 2023 and will be up for review every 5 years. Given that the garden is maintained in a

proper manner and the community as a whole is for the garden, the garden will be renewed every 5 years until something changes.

Who can use the garden and how?

The garden can be used by anyone as long as they don't damage the potential future of any of the plants or path. Respect for the plants, area and other residents that use the garden should be considered whenever using the garden.

The garden is to be used as a learning space, where residents and students can come and learn about local native plants and how they are evolved to thrive in this area with very little care. A number of the plants will be edible and/or medicinal. Visitors will be welcome to harvest any fruit that they are comfortable identifying. These will include, Salal berries, Strawberries, Serviceberries, Yarrow, nodding onion, and oregon grape. Use of these plants will be taught at the twice yearly maintenance garden parties to anyone who wishes to learn. There will also be signs identifying plants for garden visitor's use.

How do I have my opinion about this new garden heard?

You can fill out the attached form to this info sheet and drop it off at the FGCA front desk at 1330 Fairfield rd. Alternatively, you can fill out our online feedback form at:

https://docs.google.com/forms/d/e/1FAIpQLSdyKhvCB8mhtOVZOGf2_tXVfFr1ga8jm_DvLMfXKZe1s9Bj0A/viewform?vc=0&c=0&w=1&flr=0

A link to the survey is available on the FGCA website under **Events and Activities > Fairfield Community Gardens**.

You are also welcome to email the Community Garden Volunteer Coordinator at fairfieldcommunitygardens@gmail.com with any questions or concerns that you have.

Ross Bay Native Plant Garden (RB NPG) Resident Feedback Survey:

- Do you live in the Fairfield neighbourhood?

Y__ N__

- Do you want to learn about local indigenous plants?

Y__ N__

- What, if any, ideas or concerns do you have about the installation of the RB NPG?

- What would you like to see planted or installed in the RB NPG?

- Would you like to be added to our email list? We will email you about all community garden activities happening in Fairfield including the RB NPG

Y__ N__

First Name _____

Email Address _____

- What questions do you have about what will happen at the RB NPG?
